

ALUMINCO EPD VERIFIED



ALUMINCO is certified for the Environmental Product Declaration (EPD). We are motivated to constantly upgrade and optimize our procedures toward a friendlier future both for the environment and the people living within it. Staying focused on our vision, we published the EPD (Environmental Product Declaration).

The importance of sustainable practices in the aluminium systems goes through an EPD - Environmental Product Declaration - for four different products that constitute the main volume of production and sales which are the ultimate choice for projects aiming for LEED Platinum certification, one of the leading international sustainability certifications, which focuses on green building and framing the ideal conditions for people and the environment, inside the buildings.

What is EPD?

EPD is a document that through established international standards, certifies, enumerates, and counts data in the entirety of the production.

Specifically, provides measurable data which can then be used to efficiently update and keep track of every procedure and thus help maintain a lower environmental footprint and carbon emissions. According to that, the manufacturer certifies that a completely measurable “end-to-end” production procedure takes place.

EPD is further strengthened through the LCA (Life Cycle Assessment). LCA notes and optimizes the entire manufacturing process, from raw materials to the product end of life. Some of the advantages of LCA are:

- | Reduced environmental footprint
- | Reduced production costs throughout the manufacturing process
- | Positive BREEAM and LEED accreditation
- | Measurable carbon emissions data
- | Clarity in environmental consequences when it comes to building processes
- | Identifying chances for improving the environmental performance



ALUMINCO ARCHITECTURAL SYSTEMS WITHIN THE EPD FRAMEWORK

ALUMINCO's architectural systems, which belong to the EPD, stand out for their superior quality and advanced technology. They include comprehensive solutions for hinged, sliding, and folding systems, as well as for doors and curtain walls, covering a wide range of architectural applications.

OPENING SYSTEMS

W400

Tilt & Turn System

High level of flexibility.



W540

Tilt & Turn System

Affordable quality and compatibility.



W450

Tilt & Turn Thermal Insulating System

Maximum energy saving.



W450 HS

Tilt & Turn Thermal Insulating System

An exceptional aesthetic result.



W4750

Tilt & Turn Highly Thermal Insulating System

The most demanding thermal insulation requirements.



W4900

Tilt & Turn Thermal Insulating System

Innovative concept with a passive house certification.



ENTRANCE DOOR

D110

Pivot Door System

The epitome of magnificence.

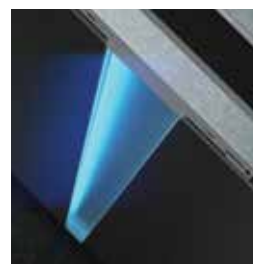

D75

High-performance Insulated Entrance Doors System

Energy efficiency, structural stability and functionality.

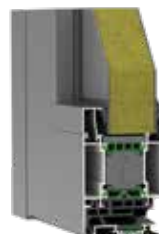

FOLDING DOOR SYSTEMS

FD75

Minimal Folding Door System

The minimal fold



FD4600

Folding Thermal Insulating Door System

High comfort & maximal transparency.



SLIDING SYSTEMS

SL320

Slide - Lift and Slide System

Sleek flat design.



SL200

Sliding Thermal Insulating System

Maximum space saving.



SL2450

Lift & Slide Thermal Insulating System
Minimal face widths.

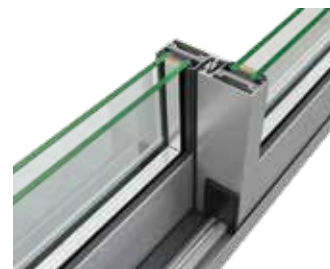

SL2700

Lift & Slide Thermal Insulating System
High-end structures.



SL2900

Sliding Thermal Insulating System with Diversion
Hyper performances.



INTERIOR PARTITIONS

OS25

Interior Partitions System
Slim design delivers maximum transparency.



SHUTTER SYSTEMS

SH3200

Shutter System
Passive solar shading suitable for residential buildings.



SH3400

Shadow System
Protection against solar radiation and controlling of the natural lighting of buildings.



CURTAIN WALL SYSTEMS

EW50

Curtain Wall System

High energy efficiency to fully meet all stability and safety requirements.

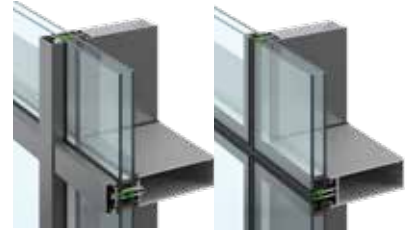

EW50 SP

Curtain Wall System

Outstanding sound performance.

